



Croft Road

Stockingford, Nuneaton, CV10 7EH

£650 PCM



Nestled in the charming area of Stockingford, Croft Road presents an inviting opportunity for those seeking a modern and comfortable living space. This recently refurbished first-floor flat boasts a delightful blend of contemporary style and practical amenities, making it an ideal choice for individuals or small families.

The property is equipped with double glazing and gas central heating, providing warmth and comfort during the cooler months.

Located in a well-connected area, residents will find themselves within easy reach of local amenities, schools, and transport links, making it a convenient choice for daily living. The surrounding community is friendly and welcoming, adding to the overall appeal of this lovely home.

In summary, this first-floor flat on Croft Road is a splendid opportunity for those looking for a stylish and comfortable residence in Stockingford. With its recent refurbishment, gas central heating, and double glazing, it promises a delightful living experience. Do not miss the chance to make this charming property your new home.



Entrance

Via double glazed door into:

Entrance Hall

Stairs to first floor landing

Landing 3'1" x 9'9" (0.93m x 2.98m)

Radiator, doors to:

Lounge 11'1" x 14'1" (3.37m x 4.29m)

Double glazed windows to front and side, radiator, door to storage cupboard housing pre-payment electric meter.

Bedroom 11'5" x 12'4" (3.47m x 3.75m)

Double glazed windows to rear and side and radiator.

Kitchen 6'6" x 7'10" (1.98m x 2.39m)

Fitted with a matching range of base and eye level units with worktop space over, stainless steel sink unit with stainless steel mixer tap, space for fridge, built in electric fan assisted oven and hob, extractor hood, wall mounted combination boiler serving heating system and domestic hot water, door to:

Shower Room 5'8" x 7'10" (1.73m x 2.40m)

Recently refitted with three piece suite with comprising, shower enclosure, vanity wash hand basin with cupboard under and mixer tap, low-level WC and heated towel rail, extractor fan, obscure double glazed window to rear, plumbing for automatic washing machine.

Area Map



Floor Plans

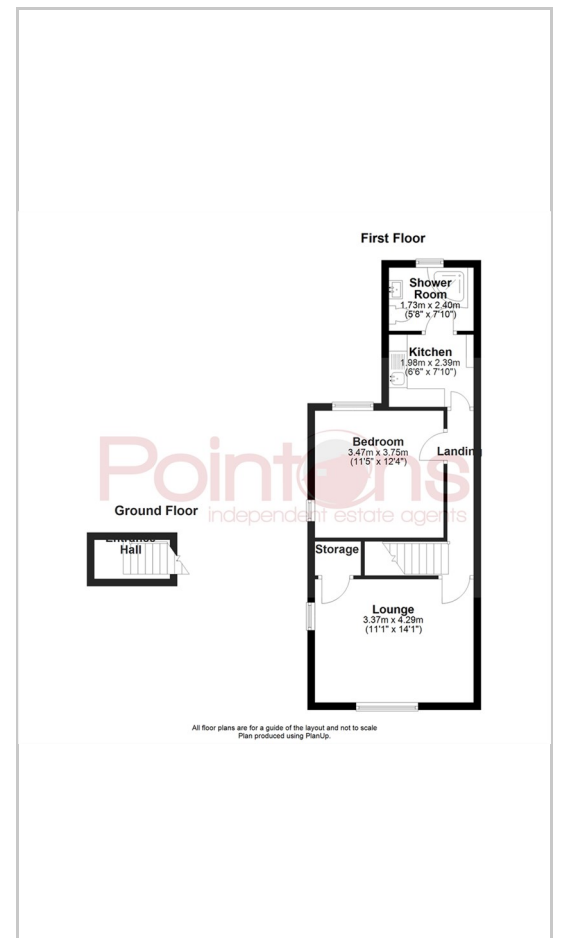

Energy Efficiency Graph

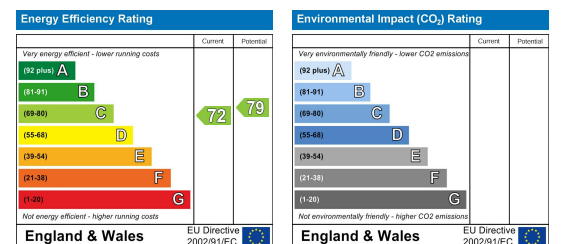

These particulars, whilst believed to be accurate are set out as a general outline only for guidance and do not constitute any part of an offer or contract. Intending purchasers should not rely on them as statements of representation of fact, but must satisfy themselves by inspection or otherwise as to their accuracy. No person in this firm's employment has the authority to make or give any representation or warranty in respect of the property.

109 NEW UNION STREET
COVENTRY, CV1 2NT
coventry@pointons-group.com
024 7710 333
Company No: 7359350



BOND GATE CHAMBERS
NUNEATON, CV11 4AL
nuneaton@pointons-group.com
024 7637 3300
Company No: 6743033

74 LONG STREET
ATHERSTONE, CV9 1AU
atherstone@pointons-group.com
01827 711911
Company No: 81323250

www.pointons-group.com

VAT NO 742186125